

MARK	DATE	REVISION

R Miller
ARCHITECTURE
INC.
1201 Parkview Avenue
Winter Park, Florida 32789
P: 407 539 2412
F: 407 539 2411
RMiller@rmlarch.com

REDDING GARDENS LIGHT IMPROVEMENTS

SANFORD, FLORIDA

PROJECT # : 202001A
DATE : 4-22-08
DRAWN BY : BCF
CHECKED BY : BCF
TITLE :
DEMOLITION ELECTRICAL
SITE PLAN
SCALE : AS NOTED
SHEET # :
E-2

© R Miller Architecture Inc. 2008

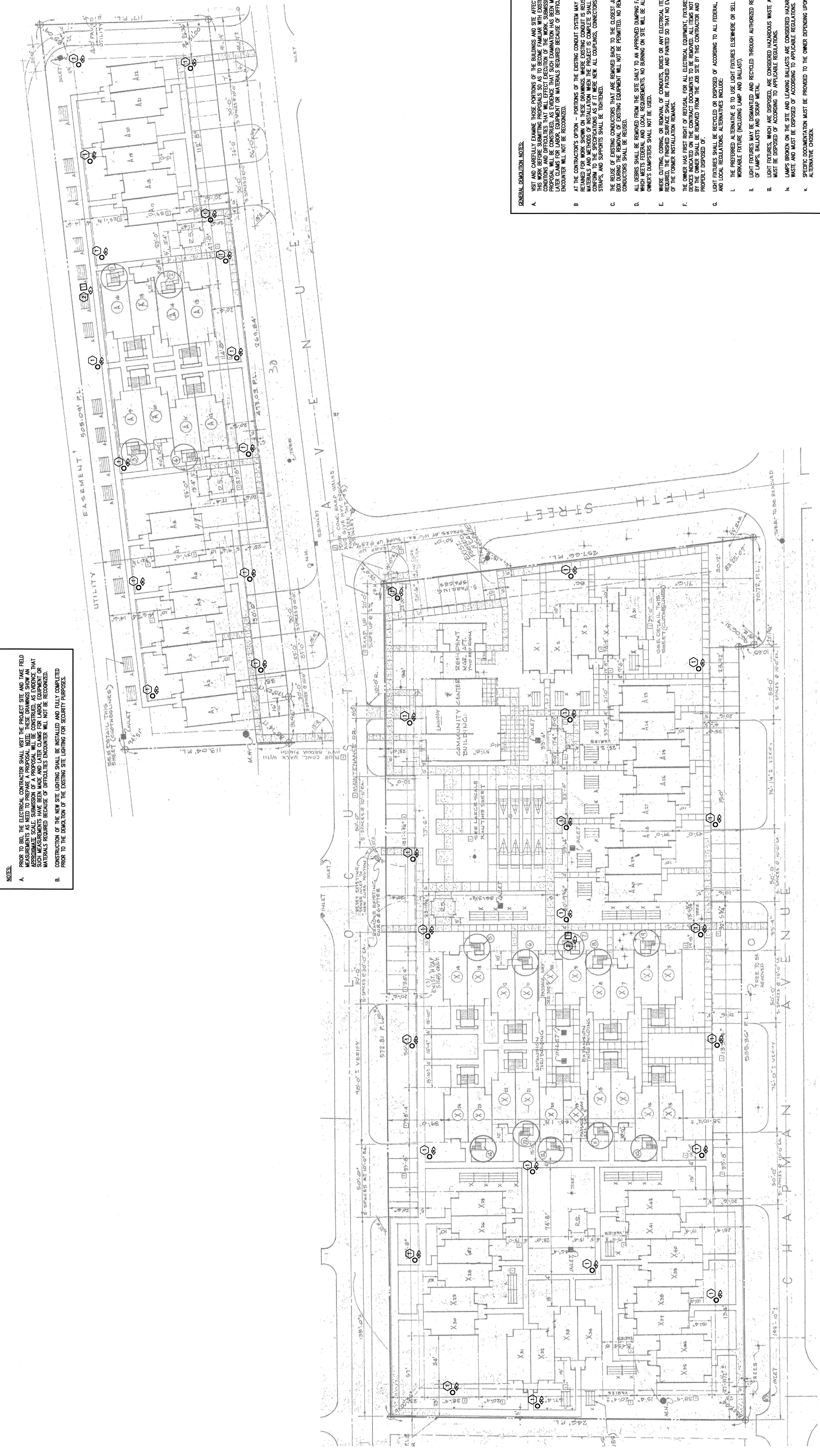

NOTES:
A. PRIOR TO BID, THE ELECTRICAL CONTRACTOR SHALL VISIT THE PROJECT SITE AND TAKE FIELD MEASUREMENTS AS NEEDED TO PREPARE A PROPOSAL. THESE DRAWINGS SHOW AN ASSUMED ELECTRICAL SYSTEM. THE CONTRACTOR SHALL VERIFY THE EXISTING ELECTRICAL SYSTEM AND MATERIALS REQUIRED BECAUSE OF DIFFICULTIES ENCOUNTERED WILL NOT BE RECORDED.
B. CONSTRUCTION OF THE NEW SITE LIGHTING SHALL BE INSTALLED AND FULLY COMPLETED PRIOR TO THE DEMOLITION OF THE EXISTING SITE LIGHTING FOR SECURITY PURPOSES.

GENERAL DEMOLITION NOTES:
A. NOT AND CAREFULLY EXAMINE THOSE PORTIONS OF THE BUILDINGS AND SITE AFFECTED BY THIS DEMOLITION. THE CONTRACTOR SHALL VERIFY THE EXISTING ELECTRICAL SYSTEM AND MATERIALS REQUIRED BECAUSE OF DIFFICULTIES ENCOUNTERED WILL NOT BE RECORDED.
B. AT THE CONTRACTOR'S OPTION - PORTIONS OF THE EXISTING CONDUIT SYSTEM MAY BE REMOVED FOR WORK SHOWN ON THESE DRAWINGS. THESE EXISTING CONDUIT IS REUSED, ITS REUSE IS AT THE CONTRACTOR'S RISK. THE CONTRACTOR SHALL VERIFY THE EXISTING ELECTRICAL SYSTEM AND MATERIALS REQUIRED BECAUSE OF DIFFICULTIES ENCOUNTERED WILL NOT BE RECORDED.
C. THE REUSE OF EXISTING CONDUIT THAT ARE REMOVED BACK TO THE CLOSEST JUNCTION BOX SHALL BE REUSED. EXISTING EQUIPMENT WILL NOT BE PERMITTED. NO REMOVED CONDUIT SHALL BE REUSED.
D. ALL DEBRIS SHALL BE REMOVED FROM THE SITE ONLY TO AN APPROVED DUMPING FACILITY WHICH MEETS FEDERAL AND LOCAL REQUIREMENTS. NO BURNING ON SITE WILL BE ALLOWED. OWNER'S DUMPSTERS SHALL NOT BE USED.
E. WHERE CUTTING, CORING, OR REMOVAL OF CONDUITS, BOXES OR ANY ELECTRICAL ITEM IS REQUIRED, THE CONTRACTOR SHALL BE PROVIDED AND PAINTED SO THAT NO EVIDENCE OF THE FORMER INSTALLATION REMAINS.
F. THE OWNER HAS FIRST RIGHT OF REFUSAL FOR ALL ELECTRICAL EQUIPMENT, EXTENDERS AND DEVICES INDICATED ON THE CONTRACT DOCUMENTS TO BE REMOVED. ALL ITEMS NOT CLAIMED BY THE OWNER SHALL BE REMOVED FROM THE JOB SITE BY THIS CONTRACTOR AND PROPERLY DISPOSED OF.
G. LIGHT FIXTURES SHALL BE RECYCLED OR DISPOSED OF ACCORDING TO ALL FEDERAL, STATE AND LOCAL REGULATIONS. ALTERNATIVES INCLUDE:
L. THE PREFERRED ALTERNATIVE IS TO USE LIGHT FIXTURES ELSEWHERE OR AS A WORKABLE FIXTURE (INCLUDING LAMP AND BALLAST)
I. LIGHT FIXTURES WHICH ARE DISPOSED, ARE CONSIDERED HAZARDOUS WASTE AND MUST BE DISPOSED OF ACCORDING TO APPLICABLE REGULATIONS.
H. LAMP BULBS ON THE SITE AND LEADING BALLASTS ARE CONSIDERED HAZARDOUS WASTE AND MUST BE DISPOSED OF ACCORDING TO APPLICABLE REGULATIONS.
X. ALTERNATIVE CHASEN
N. COORDINATE WITH THE GENERAL CONTRACTOR SO THAT OCCUPIED BUILDINGS OR PORTIONS OF BUILDINGS ARE NEVER WITHOUT LIFE SAFETY SYSTEMS INCLUDING FIRE ALARM PROTECTION THROUGHOUT ALL PHASES OF CONSTRUCTION.
L. REVIEW AND TEST EXISTING ELECTRICAL SYSTEMS (INCLUDING FIRE ALARM SYSTEM) PRIOR TO DEMOLITION. THE CONTRACTOR SHALL VERIFY THE EXISTING ELECTRICAL SYSTEM AND MATERIALS REQUIRED BECAUSE OF DIFFICULTIES ENCOUNTERED WILL BE RESPONSIBLE TO REPAIR ALL DEFICIENCIES NOT NOTED TO OWNER PRIOR TO COMMENCEMENT OF CONSTRUCTION.

GENERAL DEMOLITION SUBSCRIPTS:
A. THE FOLLOWING DEMOLITION ARE USED ON THIS DRAWING. EQUIPMENT IS EXISTING TO REMAIN UNLESS OTHERWISE NOTED:
◊ EXISTING DEMOLITION EQUIPMENT TO REMAIN
◊ EXISTING DEMOLITION EQUIPMENT TO BE REMOVED
◊ EXISTING DEMOLITION EQUIPMENT LOCATION TO REMAIN AND BE REUSED WITH NEW DEMOLITION EQUIPMENT. SEE DEMOLITION PLAN FOR FURTHER INFORMATION.
◊ EXISTING DEMOLITION EQUIPMENT TO BE REUSED

DEMOLITION NOTES:
1. DISCONNECT AND REMOVE ALL EXISTING PIPES AND FIXTURES SCHEDULED FOR DEMOLITION. CAREFULLY REVIEW ELECTRICAL DRAWINGS PRIOR TO BID. UNLESS OTHERWISE NOTED, ALL EXISTING ELECTRICAL SYSTEMS SHALL BE REMOVED. THE CONTRACTOR SHALL VERIFY THE EXISTING ELECTRICAL SYSTEM AND MATERIALS REQUIRED BECAUSE OF DIFFICULTIES ENCOUNTERED WILL NOT BE RECORDED. THE CONTRACTOR SHALL BE RESPONSIBLE TO REPAIR ALL DEFICIENCIES NOT NOTED TO OWNER PRIOR TO COMMENCEMENT OF CONSTRUCTION.
2. EXISTING 120/208V, 3PH, UTILITY TRANSFORMER TO REMAIN. FIELD VERIFY LOCATION PRIOR TO BID.

DEMOLITION ELECTRICAL SITE PLAN
SCALE: 1" = 7'-30"-0"

Innovative
Engineering, Inc.
P.O. Box 941428, Maitland, FL 32794
(407) 949-0794 Phone/Fax
www.innovativeeng.com
Certificate of Accreditation No.: 24684
Paul C. Trubbs
P.E., F.S.E.
E-2